

richard
james



2 Vesta Close

Blunsdon, Swindon, SN26 8AJ

Guide Price
£265,000





2 Vesta Close

Blunsdon, Swindon, SN26 8AJ

Freehold | EPC Rating - B
Council Tax Band C



Located within the ever-popular Blunsdon Village, this beautifully presented two-bedroom home offers modern, well-planned accommodation extending to approximately 714 sq ft. Perfectly suited to first-time buyers, downsizers or investors, the property combines contemporary styling with a practical layout and a convenient village setting.

The ground floor is accessed via a welcoming entrance hall, which provides access to a useful cloakroom and the staircase to the first floor. To the front of the property is the modern fitted kitchen, finished with a range of contemporary units, generous worktop space and appliances. The kitchen enjoys a pleasant outlook and offers a bright and functional cooking space.

To the rear sits a spacious reception/dining room creating a comfortable and versatile living area. There is ample room for both lounge and dining furniture, making it ideal for everyday living as well as entertaining. The layout allows for a natural flow between the living and dining areas, with space to relax or host guests.



Charlie Berry
Branch Manager

01793 311 043
07470 489 292

charlieberry@richardjames.uk



Scan here

Kitchen





Upstairs, the first floor landing provides access to two well-proportioned double bedrooms and the family bathroom. Both bedrooms offer comfortable accommodation and are versatile enough to suit a variety of needs, whether as guest rooms, a home office or additional storage space. They are served by a stylish, modern family bathroom fitted with a contemporary white suite and shower over the bath.

Externally, the property benefits from an enclosed rear garden, providing a low-maintenance outdoor space ideal for relaxing or entertaining. To the front, there is off-road parking for two vehicles, adding everyday practicality.

Principal
bedroom





This vibrant village benefits from a welcoming community shop/cafe and two public houses, village hall, in addition to Flame Restaurant and many leisure facilities at the Blunsdon House Hotel. There is a local school, St Leonards CE Primary, and both Warneford Secondary school in Highworth (4 miles) and Farmors Secondary school in Fairford (10 miles) have bus services running from the village.

There is also a bus service available to Cirencester College. With good road links via the A419 to the M5 and M4, and Swindon railway station (circa five miles) providing regular links to London (within an hour), this is a superb opportunity to get the best of both worlds whilst also being accessible.

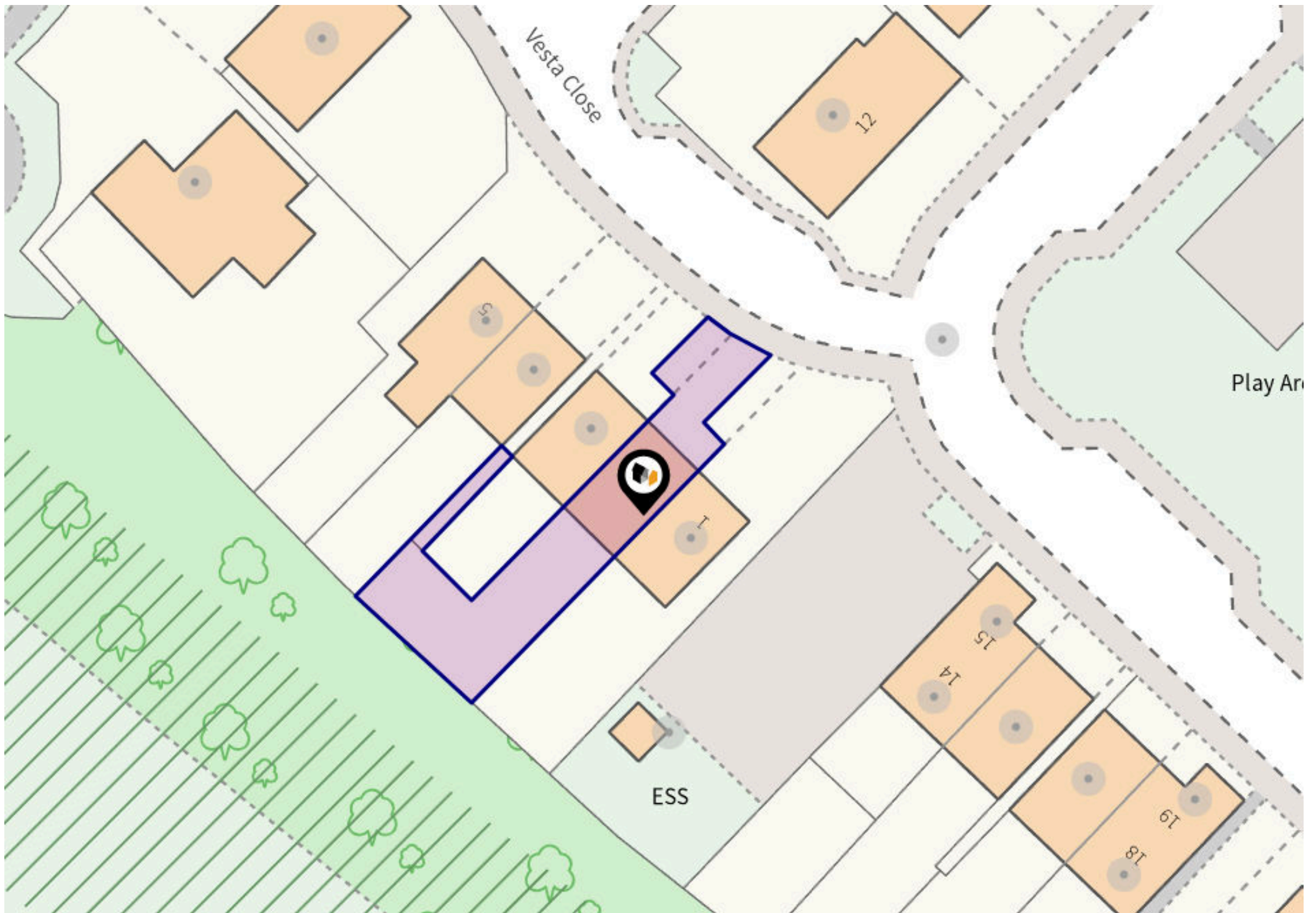



Approximate Area = 714 sq ft / 66.3 sq m

For identification only - Not to scale

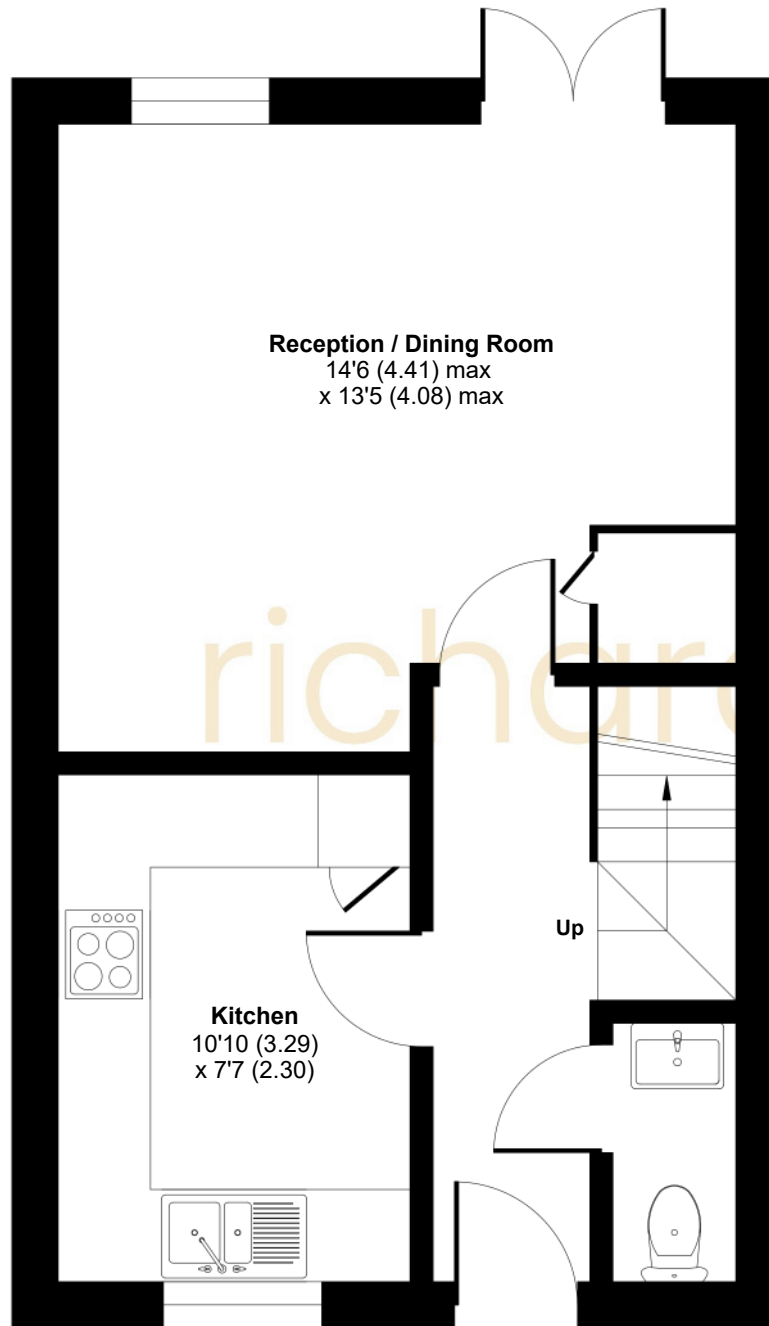

GROUND FLOOR

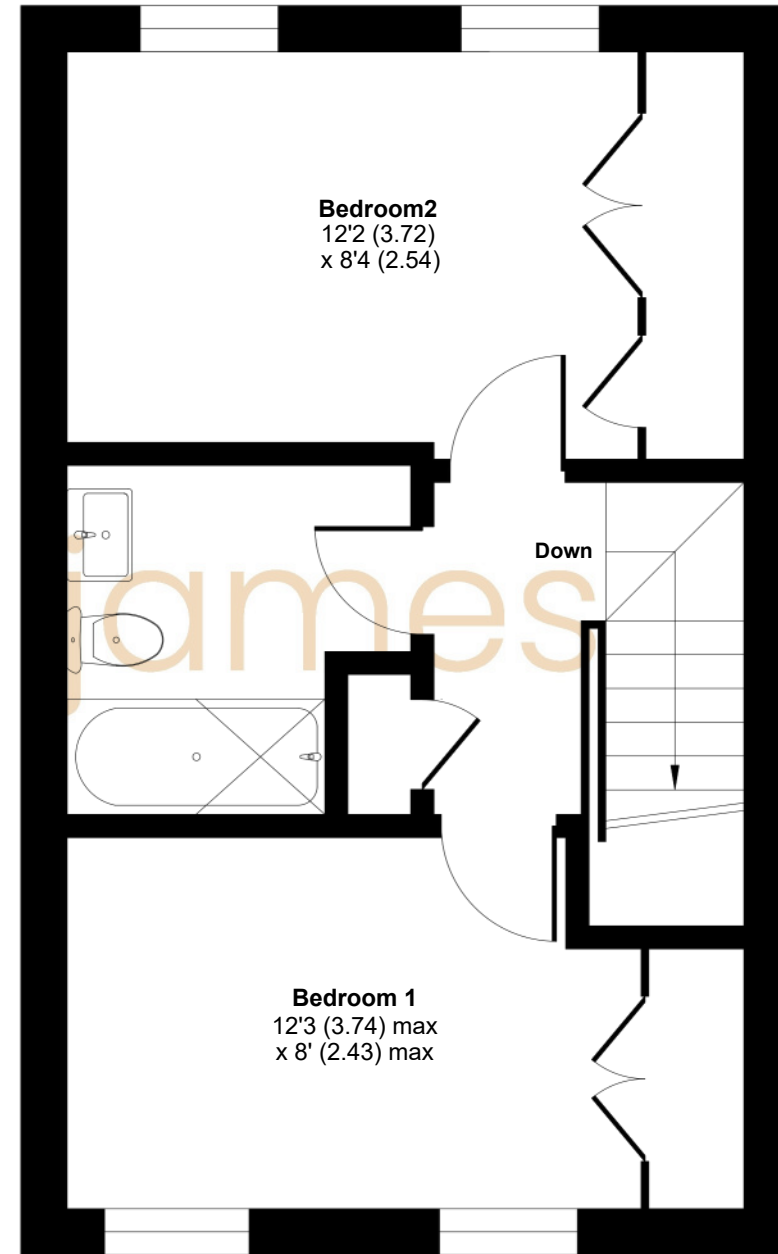

FIRST FLOOR