

richard
james



John Alder Close

Chiseldon, SN4 0JL

Guide Price
£310,000 - £330,000





John Alder Close

Chiseldon, SN4 0JL

Freehold | EPC Rating - C

 3  2  2

Situated in the heart of Chiseldon, this well-presented three-bedroom property offers excellent access to the M4 motorway, the A419 and the Great Western Hospital, making it ideal for commuters and families alike.

The home is also conveniently located within easy reach of Three Trees Farm Shop, as well as beautiful countryside walks and a selection of charming village pubs.



James Sargeant
Sales Negotiator/Lister

01793 814 542

jamesargeant@richardjames.uk

   @rjestateagent



Scan here

OPEN
PLAN
KITCHEN /
DINER





The property itself is thoughtfully arranged across three floors. Upon entering, you are welcomed by an entrance hallway leading to a convenient cloakroom, a comfortable living room, and a spacious kitchen/dining room—perfect for both everyday living and entertaining.

The first floor comprises two well-proportioned bedrooms, along with a fully fitted family bathroom suite. Occupying the entire second floor is the impressive master suite, featuring a walk-in wardrobe and a private ensuite shower room.

EN-SUITE
TO
MASTER





Externally, the property benefits from enclosed gardens, a garage, and driveway parking, as well as an electric vehicle charging point.

Further features include built-in wardrobes in all bedrooms, gas central heating and double glazing throughout.



Approximate Area = 1048 sq ft / 97.3 sq m
Garage = 145 sq ft / 13.4 sq m
Total = 1193 sq ft / 110.7 sq m
For identification only - Not to scale

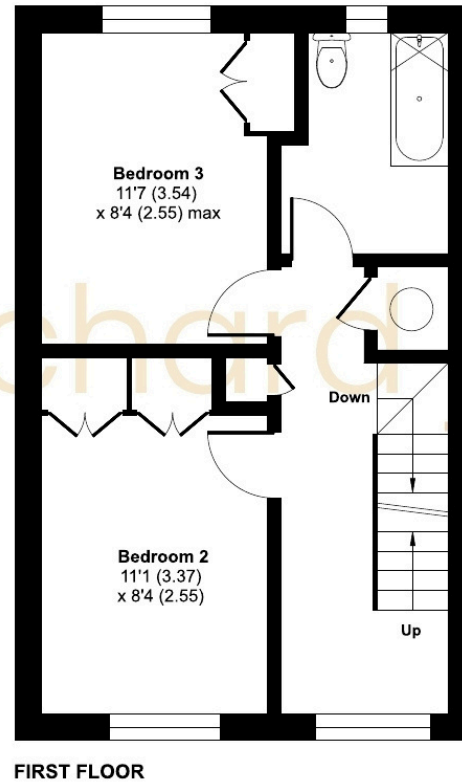
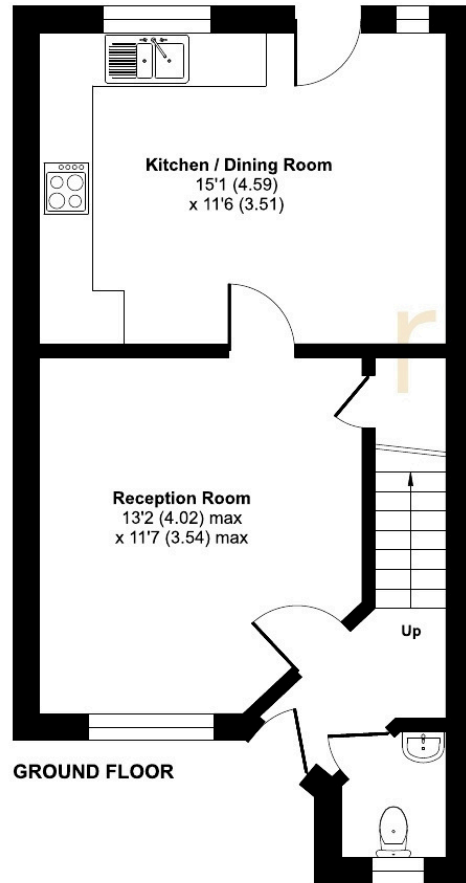

 Floor plan produced in accordance with RICS Property Measurement 2nd Edition, Incorporating International Property Measurement Standards (IPMS2 Residential). © nichecom 2026. Produced for Richard James. REF: 1447598

01793 814 542

wroughton@richardjames.uk

80 High Street | Wroughton | SN4 9JZ

richardjames.uk



@rjstateagent