

richard
james



Dykes Mews

Chiseldon, SN4 0NF

Fixed Price
£230,000





Dykes Mews

Chiseldon, SN4 0NF

Freehold | EPC Rating - D

 2  1  1

A beautifully presented two-bedroom end-of-terrace home, situated in the quiet cul-de-sac of Dykes Mews within the sought-after village of Chiseldon.

The property offers a well-balanced layout, with a modern kitchen positioned to the front and a spacious living/dining area to the rear leading to the generous garden, providing an ideal space for both relaxing and entertaining.

Upstairs, there are two good-sized bedrooms along with a well-appointed family bathroom, making the home perfectly suited to first-time buyers, downsizers, or investors.



Ellis-Rose Wigley
Branch Manager

01793 814 542

ellisrosewigley@richardjames.uk

 @rjstateagent



Scan here

Large
Master
Bedroom





Externally, the property benefits from a low-maintenance rear garden, ideal for outdoor enjoyment with minimal upkeep, as well as the added advantage of a separate garage.

Surrounded by scenic countryside, Chiseldon is a charming and well-regarded village located on the edge of the Marlborough Downs. The village provides a range of local amenities including a primary school. With fantastic access to both the M4 and A419.

Generous
Rear
Garden



Approximate Area = 604 sq ft / 56.1 sq m
Garage = 174 sq ft / 16.2 sq m
Total = 778 sq ft / 72.3 sq m
For identification only - Not to scale



GROUND FLOOR

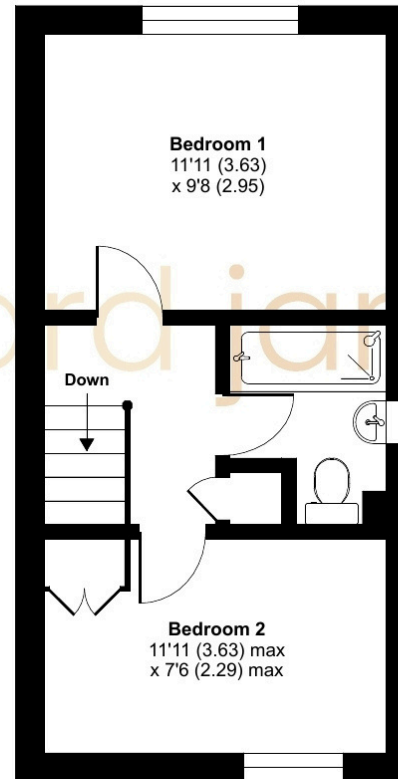

FIRST FLOOR

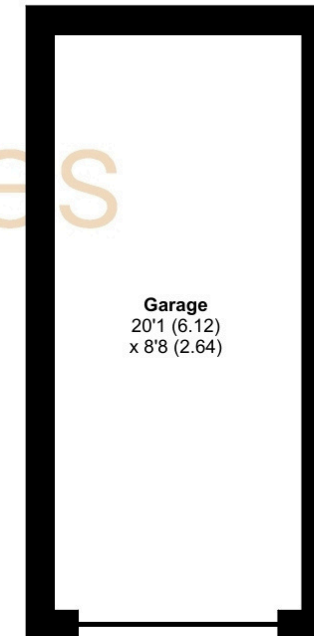

Floor plan produced in accordance with RICS Property Measurement 2nd Edition, Incorporating International Property Measurement Standards (IPMS2 Residential). © nchecon 2026. Produced for Richard James. REF: 1484516

01793 814 542

wroughton@richardjames.uk

80 High Street | Wroughton | SN4 9JZ

richardjames.uk

