



22, Westbury Park, Royal Wootton Bassett, SN4 7DL

Guide Price: £220,000

richard james

Village & Country Homes

richard james



Westbury Park

Royal Wootton Bassett

Freehold



No Chain!!!

A Rare Opportunity To Acquire A Two Bedroom Home in Royal Wootton Bassett.

Well Positioned Close For Shops, Schools And Amenities The Accommodation Comprises Entrance Hall, Kitchen, Living Room Leading Onto The Pleasant Rear Garden, Landing, Two Bedrooms, Bathroom, Front And Rear Gardens, Allocated Parking, Gas Heating.

We Recommended A Viewing To Appreciate This Fantastic Home.





richard james



richard james



richard james



richard james



richard james





richard james



richard james

Floorplan

Approximate Area = 594 sq ft / 55.1 sq m

For identification only - Not to scale



GROUND FLOOR

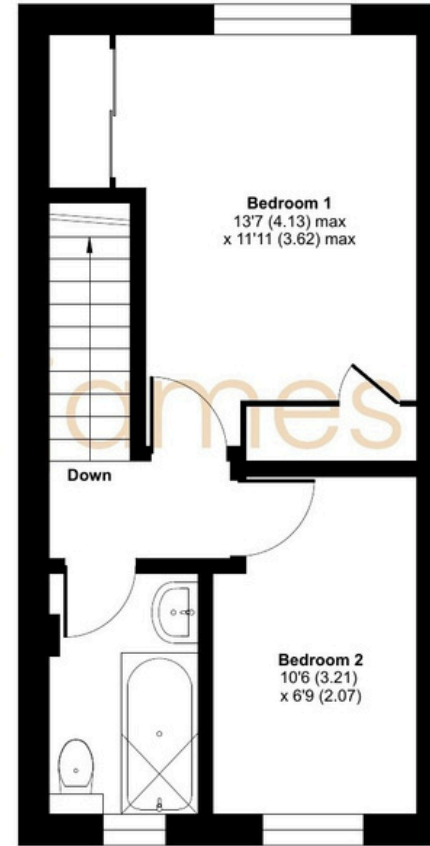

FIRST FLOOR

 Floor plan produced in accordance with RICS Property Measurement 2nd Edition, incorporating International Property Measurement Standards (IPMS2 Residential). © nrichcom 2026. Produced for Richard James. REF: 1487968

01793 855 117

rwb@richardjames.uk

139 High Street | Royal Wootton Bassett | SN4 7AY

richard james

richardjames.uk